

Art that  
**FIGHTS**  
fire

*Technical Data Sheet*  
VSD - EI<sub>2</sub>120

**meverin**<sup>®</sup>  
F I R E D O O R S

# EN FF C EI<sub>2</sub> 120 VERTICAL SLIDING DOOR



## EN FF CE EI<sub>2</sub> 120 VERTICAL SLIDING DOOR

### TECHNICAL FEATURES

#### Side sliding guide

Sliding on side sliding guides and anti-friction flame guard counter-slides.

#### Leaf for SMALL size vertical sliding doors

Made in a single panel with sheet metal on the two external faces with programmed deformability. MEV FIRUX® (patented) new internal insulating pack, resistant to high temperatures. The door is supplied **fully assembled** and ready to be dowelled to the wall.

#### Leaf for LARGE size vertical sliding doors

Made with cut-to-measure modular panels assembled through **coplanar male/female joints (patented)** and fixed on both sides by visible screws (the screws are included in the supply). Sheet metal on the two external faces with programmed deformability. MEV FIRUX® (patented) **new internal insulating pack**, resistant to high temperatures.

**Guided and facilitated assembly sequence thanks to the complete preparation of all the details (thoroughly vetted at the factory) and the numerical progression shown on the panels with the absolute advantage of a successful installation and reduced installation times.**

#### Handles

Recessed on both sides of the leaf, positioned on the bottom end.

#### Smoke labyrinth seals

Fixed labyrinth seals in press-folded sheet steel.

#### FIRUX® type intumescent fire seal

Placed on all labyrinth seals.

#### Counterbalance weights

Adjustable balancing counterbalance weights.

#### Accident prevention safety system

Hydraulic speed control device VT (Viscotroller®).

#### Operation (door hold-open retainer)

Standard with electromagnet as per DoP declaration.

#### Applications

- surface mounted on solid and load-bearing **masonry** or reinforced concrete wall
- on **wall**
- on insulated and protected **metal bearing frame**.

#### Finish

The sliding doors are made of **galvanized sheet metal and finished with an ecological primer paint**, of industrial type, with high quality epoxy resins, which guarantee protection against corrosion from a vast range of aggressive agents, acid and non-acid, in environments not directly exposed to the outdoor natural atmosphere. Standard color RAL 7035. The full range of RAL and NCS is available on order.

**NEW:** execution in AISI 304 o 316 stainless steel (excluding accessories)

#### Identification plate

Applied on the shell handle with the appropriate CE mark and with personalized polychrome CARD with identification data.

#### Documentation provided (CE marking)

Composed by:

- DoP declaration of performance
- declaration of conformity with machinery directive
- installation, use and maintenance manual
- installation instructions

#### LEAF weight and thickness

- Average nominal weight 51 kg/m<sup>2</sup>
- Nominal thickness 100 mm

#### EI<sub>2</sub> 120 field of application with CE marking

| Vertical Sliding Door EI <sub>2</sub> 120 |           |         |
|---|-----------|---------|
|   | LN        | HN      |
| Maximum dimensions                        | 4350 mm   | 4200 mm |
| Maximum surface                           | 13,27 mq  |         |
| Size decreasing                           | UNLIMITED |         |

EN FF CE EI<sub>2</sub> 120 VERTICAL SLIDING DOOR

1 LEAF VERSION - CE MARKED - COMPLYING WITH EN 16034 - EN 13241

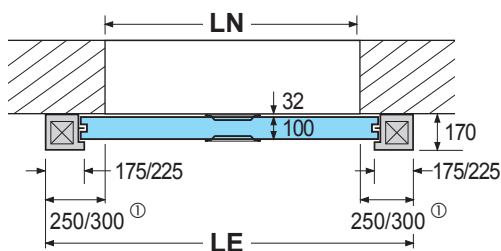
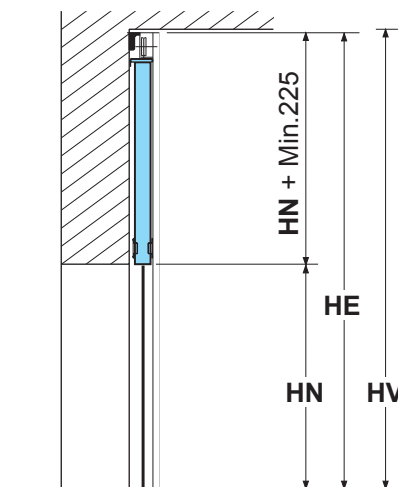
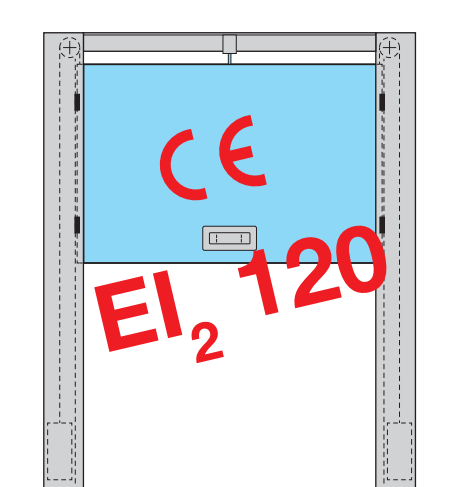

POSSIBLE INSTALLATIONS:

- APPLICATION ON WALL
- APPLICATION ON WINDOWS
- APPLICATION ON INSULATED AND PROTECTED METAL BEARING FRAME

Fig. 1

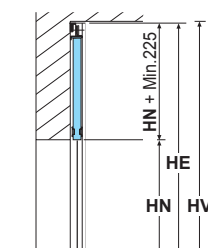

Application on wall.

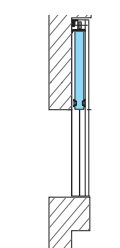

Application on windows.

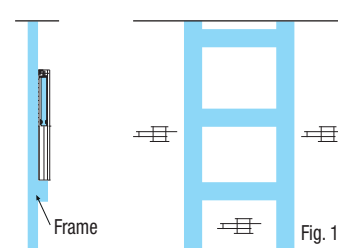

Bearing frame example in insulated steel pipe 100x250 mm by mineral wool (density 120kg/m³) and coated by 12,5mm drywall plates (plates at customer charge).

NOTE

- Low traffic flow fire compartmentation element not to be used improperly.
- Install in environments not subject to air drafts.
- Assembly to be carried out only by specialized personnel.
- Install only on perfectly square and level compartments or structures.
- Door with limited movement, to be used only as a technical compartment and not for the passage of people.
- Precaution in use and risk analysis are the responsibility of the customer.
- For special cases indicate the spaces available and apply to our technical department.
- Detection system, preferably centralized, to be provided by and at the expense of the customer.

① For the actual overall dimensions, apply to the technical department.

- Drawings are provided by way of example therefore they are out of scale.
- The dimensions are expressed in millimeters.
- The protocol number will be attributed upon order or production confirmation.
- Meverin reserves the right to make any changes it deems appropriate to this document at any time and without notice.



Modules with programmed deformability

SEE ACCESSORIES ON PAGE 4 →

## ACCESSORIES

Check the perfect operation of the door and of the door closing systems.

